

LOCATION MAP

NO SCALE

SEC. 12, TWP. 43, RNG. 42

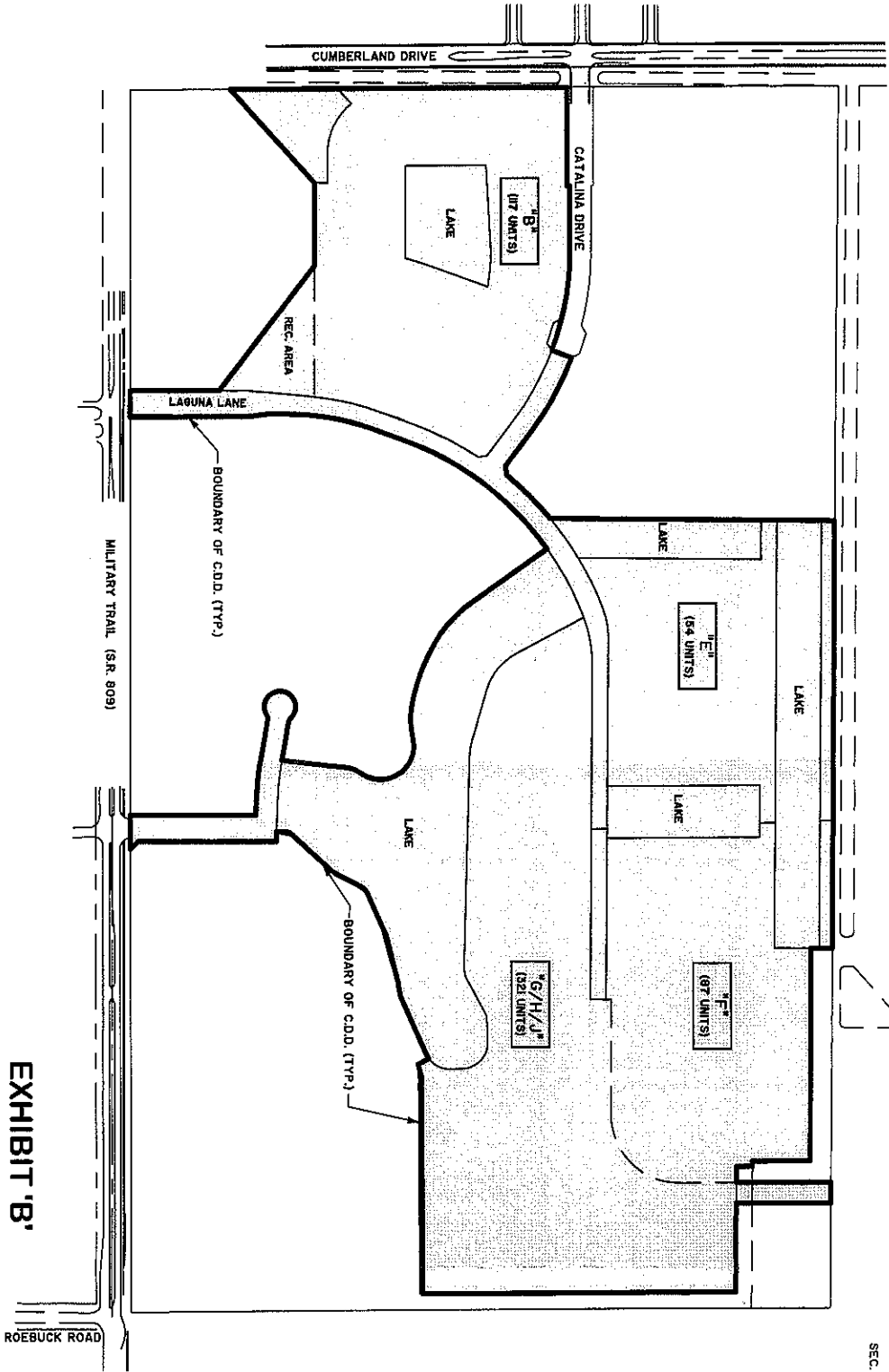

SARATOGA POINTE
(TRACTS DD, EE, FF, VILLAGES OF PALM BEACH LAKES)

EXHIBIT 'B'

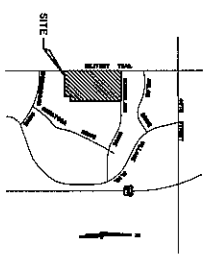

LOCATION MAP
SEC. 12, TWP. 43, RNG. 42

JOB NO.	
SHEET NO.	

SCALE:	DESIGNED BY: F. ROTH	DRAWN BY: MAM
REVISIONS:	DATE	BY

PROJECT:	BRIGER CDD
DESCRIPTION:	DISTRICT MAP

MICHAEL B. SCHORAH & ASSOCIATES, INC.
ENGINEERS • SURVEYORS • PLANNERS
DEVELOPMENT CONSULTANTS

TEL. (561) 833-0200
TEL. (561) 833-7722
1850 FOREST HILL BLVD.,
WEST PALM BEACH, FLORIDA 33405

LEGAL DESCRIPTION

A PARCEL OF LAND BEING A PORTION OF BRIGER TRACT PLAT NO. 1, AS RECORDED IN PLAT BOOK 54, PAGE 35, PUBLIC RECORDS OF PALM BEACH COUNTY, FLORIDA, AND A PORTION OF WINDSOR AT PALM BEACH LAKES, AS RECORDED IN PLAT BOOK 89, PAGES 117 THROUGH 120, PUBLIC RECORDS OF PALM BEACH COUNTY, FLORIDA, AND ALL OF BRIGER PARCELS B, E AND F, AS RECORDED IN PLAT BOOK 90, PAGES 137 THROUGH 144, PUBLIC RECORDS OF PALM BEACH COUNTY, FLORIDA, SAID PARCEL BEING MORE PARTICULARLY DESCRIBED AS FOLLOWS:

COMMENCING AT THE NORTHWEST CORNER OF SAID BRIGER TRACT PLAT NO. 1; THENCE SOUTH 88°14'08" EAST, ALONG THE NORTH LINE OF SAID BRIGER TRACT PLAT NO. 1, A DISTANCE OF 379.44 FEET TO THE POINT OF BEGINNING; THENCE CONTINUE SOUTH 88°14'08" EAST ALONG THE NORTH LINE OF SAID BRIGER TRACT PLAT NO. 1, A DISTANCE OF 1280.56 FEET TO THE NORTHWEST CORNER OF THE LAKES OF LAGUNA, AS RECORDED IN PLAT BOOK 75, PAGES 162 THROUGH 165, PUBLIC RECORDS OF PALM BEACH COUNTY, FLORIDA; THENCE SOUTH 01°45'52" WEST ALONG THE WEST LINE OF SAID PLAT OF THE LAKES OF LAGUNA, A DISTANCE OF 376.00 FEET; THENCE SOUTH 88°14'08" EAST, A DISTANCE OF 10.00 FEET; THENCE SOUTH 01°45'52" WEST, A DISTANCE OF 248.68 FEET TO THE POINT OF CURVATURE OF A CURVE CONCAVE TO THE NORTHWEST; THENCE SOUTHWESTERLY ALONG THE ARC OF SAID CURVE, HAVING A CENTRAL ANGLE OF 20°51'06" AND A RADIUS OF 1058.00 FEET, A DISTANCE OF 385.04 FEET; THENCE SOUTH 67°23'02" EAST ALONG A LINE RADIAL TO SAID CURVE, A DISTANCE OF 80.00 FEET TO A POINT ON A CURVE CONCAVE TO THE NORTHWEST AND WHOSE CHORD BEARS SOUTH 30°33'09" WEST; THENCE SOUTHWESTERLY ALONG THE ARC OF SAID CURVE, HAVING A CENTRAL ANGLE OF 15°52'21" AND A RADIUS OF 1138.00 FEET, A DISTANCE OF 315.26 FEET; THENCE SOUTH 38°29'19" WEST, A DISTANCE OF 166.63 FEET; THENCE SOUTH 05°01'09" EAST, A DISTANCE OF 34.42 FEET TO A POINT ON A CURVE CONCAVE TO THE SOUTHWEST AND WHOSE CHORD BEARS SOUTH 43°04'31" EAST; THENCE SOUTHEASTERLY ALONG THE ARC OF SAID CURVE, HAVING A CENTRAL ANGLE OF 10°54'13" AND A RADIUS OF 1223.54 FEET, A DISTANCE OF 232.84 FEET TO A POINT ON THE SOUTH LINE OF SAID PLAT OF THE LAKES OF LAGUNA; THENCE SOUTH 87°38'08" EAST ALONG SAID SOUTH LINE, A DISTANCE OF 1082.78 FEET TO THE SOUTHEAST CORNER OF SAID PLAT OF THE LAKES OF LAGUNA AND A POINT ON THE EAST LINE OF SAID BRIGER TRACT PLAT NO. 1; THENCE SOUTH 02°21'52" WEST ALONG SAID EAST LINE, A DISTANCE OF 359.45 FEET; THENCE SOUTH 02°21'42" WEST, A DISTANCE OF 1273.20 FEET; THENCE NORTH 87°38'18" WEST, A DISTANCE OF 81.00 FEET; THENCE SOUTH 02°21'42" WEST, A DISTANCE OF 804.90 FEET; THENCE NORTH 88°19'12" WEST, A DISTANCE OF 219.02 FEET; THENCE SOUTH 02°21'42" WEST, A DISTANCE OF 20.00 FEET; THENCE NORTH 88°19'12" WEST, A DISTANCE OF 61.01 FEET; THENCE SOUTH 02°21'42" WEST, A DISTANCE OF 61.01 FEET TO A POINT ON THE NORTH LINE OF PARCEL 4 AS SHOWN ON SAID BRIGER TRACT PLAT NO. 1; THENCE SOUTH 88°19'12" EAST ALONG SAID NORTH LINE OF PARCEL 4, A DISTANCE OF 361.03 FEET TO A POINT ON THE EAST LINE OF SAID BRIGER TRACT PLAT NO. 1; THENCE SOUTH 02°21'42" WEST ALONG SAID EAST LINE, A DISTANCE OF 80.01 FEET TO THE SOUTHEAST CORNER OF SAID PARCEL 4; THENCE NORTH 88°19'12" WEST ALONG THE SOUTH LINE OF SAID PARCEL 4, A DISTANCE OF 361.03 FEET; THENCE SOUTH 02°21'42" WEST, A DISTANCE OF 339.02 FEET; THENCE NORTH 88°19'12" WEST, A DISTANCE OF 1189.66 FEET; THENCE NORTH 01°40'48" EAST, A DISTANCE OF 826.47 FEET; THENCE NORTH 11°39'13" WEST, A DISTANCE OF 49.33 FEET; THENCE NORTH 61°50'30" EAST, A DISTANCE OF 43.74 FEET; THENCE NORTH

THIS IS NOT A BOUNDARY SURVEY

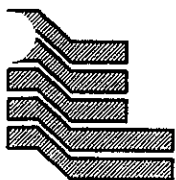

Landmark Surveying & Mapping Inc.
 1850 FOREST HILL BOULEVARD, SUITE 100
 WEST PALM BEACH, FL 33406
 PHONE : (561) 433-5405
 LB #4396

WESTBROOK

FIELD:	N/A	DRAWN:	L.C.B.	SCALE:	N/A
BOOK:	N/A	DATE:	AUG., 2001	PROJ. FILE	2504
PAGE:	N/A	CHECKED:	C.S.P.	CADDFILE	2504_F

SHEET NO.	1	OF	9	JOB NO.	2504
-----------	---	----	---	---------	------

22°04'18" WEST, A DISTANCE OF 252.47 FEET TO THE POINT OF CURVATURE OF A CURVE CONCAVE TO THE NORTHEAST; THENCE NORTHWESTERLY ALONG THE ARC OF SAID CURVE, HAVING A CENTRAL ANGLE OF 13°56'57" AND A RADIUS OF 50.00 FEET, A DISTANCE OF 12.17 FEET; THENCE NORTH 08°07'21" WEST, A DISTANCE OF 48.24 FEET; THENCE NORTH 12°06'07" WEST, A DISTANCE OF 185.07 FEET; THENCE NORTH 22°33'20" WEST, A DISTANCE OF 173.87 FEET TO THE POINT OF CURVATURE OF A CURVE CONCAVE TO THE SOUTHWEST; THENCE NORTHWESTERLY ALONG THE ARC OF SAID CURVE, HAVING A CENTRAL ANGLE OF 38°06'17" AND A RADIUS OF 50.00 FEET, A DISTANCE OF 33.25 FEET; THENCE NORTH 60°39'38" WEST, A DISTANCE OF 113.85 FEET TO THE POINT OF CURVATURE OF A CURVE CONCAVE TO THE NORTHEAST; THENCE NORTHWESTERLY ALONG THE ARC OF SAID CURVE HAVING A CENTRAL ANGLE OF 15°32'03" AND A RADIUS OF 50.00 FEET, A DISTANCE OF 13.56 FEET; THENCE NORTH 45°07'35" WEST, A DISTANCE OF 212.87 FEET TO THE POINT OF CURVATURE OF A CURVE CONCAVE TO THE SOUTHWEST; THENCE NORTHWESTERLY ALONG THE ARC OF SAID CURVE HAVING A CENTRAL ANGLE OF 40°52'09" AND A RADIUS OF 15.00 FEET, A DISTANCE OF 10.70 FEET; THENCE NORTH 85°59'44" WEST, A DISTANCE OF 43.41 FEET; THENCE SOUTH 03°56'43" WEST, A DISTANCE OF 38.51 FEET; THENCE NORTH 88°13'17" WEST, A DISTANCE OF 524.13 FEET; THENCE SOUTH 46°56'43" WEST, A DISTANCE OF 42.43 FEET TO A POINT ON THE EAST RIGHT-OF-WAY LINE OF MILITARY TRAIL AS PER OFFICIAL RECORD BOOK 4617, PAGE 1242, AND THE WEST LINE OF SAID BRIGER TRACT PLAT NO. 1; THENCE NORTH 01°56'43" EAST ALONG SAID EAST RIGHT-OF-WAY LINE OF MILITARY TRAIL AND WEST LINE OF BRIGER TRACT PLAT NO. 1, A DISTANCE OF 130.00 FEET; THENCE SOUTH 88°03'17" EAST, A DISTANCE OF 477.57 FEET; THENCE NORTH 03°56'43" EAST, A DISTANCE OF 68.98 FEET TO THE POINT OF CURVATURE OF A CURVE CONCAVE TO THE EAST; THENCE NORTHERLY ALONG THE ARC OF SAID CURVE HAVING A CENTRAL ANGLE OF 08°40'11", AND A RADIUS OF 1040.00, A DISTANCE OF 157.37 FEET; THENCE NORTH 12°36'54" EAST, A DISTANCE OF 70.51 FEET TO THE POINT OF CURVATURE OF A CURVE CONCAVE TO THE NORTHWEST; THENCE NORTHEASTERLY ALONG THE ARC OF SAID CURVE HAVING A CENTRAL ANGLE OF 02°06'56", AND A RADIUS OF 1960.00 FEET, A DISTANCE OF 72.37 FEET TO THE POINT OF COMPOUND CURVATURE OF A CURVE CONCAVE TO THE SOUTHWEST; THENCE NORTHWESTERLY ALONG THE ARC OF SAID CURVE HAVING A CENTRAL ANGLE OF 40°55'24", AND A RADIUS OF 25.00, A DISTANCE OF 17.86 FEET TO THE POINT OF REVERSE CURVATURE OF A CURVE CONCAVE TO THE SOUTH; THENCE NORTHERLY, EASTERLY, AND SOUTHERLY ALONG THE ARC OF SAID CURVE HAVING A CENTRAL ANGLE OF 260°13'32", AND A RADIUS OF 60.00 FEET, A DISTANCE OF 272.51 FEET TO THE POINT OF REVERSE CURVATURE OF A CURVE CONCAVE TO THE SOUTHWEST; THENCE SOUTHWESTERLY ALONG THE ARC OF SAID CURVE HAVING A CENTRAL ANGLE OF 39°21'12", AND A RADIUS OF 25.00 FEET, A DISTANCE OF 17.17 FEET TO THE POINT OF REVERSE CURVATURE OF A CURVE CONCAVE TO THE NORTHWEST; THENCE SOUTHWESTERLY ALONG THE ARC OF SAID CURVE HAVING A CENTRAL ANGLE OF 02°10'00", AND A RADIUS OF 2040.00 FEET, A DISTANCE OF 77.14 FEET; THENCE SOUTH 12°36'54" WEST, A DISTANCE OF 70.51 FEET; THENCE SOUTH 81°29'43" EAST, A DISTANCE OF 248.18 FEET TO THE POINT OF CURVATURE OF A CURVE CONCAVE TO THE SOUTHWEST; THENCE SOUTHEASTERLY ALONG THE ARC OF SAID CURVE HAVING A CENTRAL ANGLE OF 29°41'13", AND A RADIUS OF 108.00 FEET, A DISTANCE OF 55.96 FEET TO THE POINT OF REVERSE CURVATURE OF A CURVE CONCAVE TO THE NORTHWEST; THENCE NORTHEASTERLY ALONG THE ARC OF SAID CURVE HAVING A CENTRAL ANGLE OF 139°44'40" AND A RADIUS OF 128.29, A DISTANCE OF 312.89 FEET TO THE POINT OF REVERSE CURVATURE OF A CURVE CONCAVE TO THE EAST; THENCE NORTHERLY ALONG THE ARC OF SAID CURVE, HAVING A CENTRAL ANGLE OF 23°18'31" AND A RADIUS OF 300.00 FEET, A DISTANCE OF 122.04 FEET TO THE POINT OF COMPOUND CURVATURE OF A CURVE CONCAVE TO THE SOUTHWEST; THENCE NORTHEASTERLY ALONG THE

THIS IS NOT A BOUNDARY SURVEY

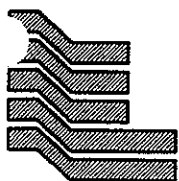

Landmark Surveying & Mapping Inc.

1850 FOREST HILL BOULEVARD, SUITE 100
 WEST PALM BEACH, FL 33406
 PHONE : (561) 433-5405
 LB #4396

WESTBROOK

FIELD:	N/A	DRAWN:	L.C.B.	SCALE:	N/A
BOOK:	N/A	DATE:	AUG., 2001	PROJ. FILE	2504
PAGE:	N/A	CHECKED:	C.S.P.	CADDFILE	2504_F

SHEET NO. 2 OF 9

JOB NO. 2504

LEGAL DESCRIPTION

A PARCEL OF LAND BEING A PORTION OF BRIGER TRACT PLAT NO. 1, AS RECORDED IN PLAT BOOK 54, PAGE 35, PUBLIC RECORDS OF PALM BEACH COUNTY, FLORIDA, AND A PORTION OF WINDSOR AT PALM BEACH LAKES, AS RECORDED IN PLAT BOOK 89, PAGES 117 THROUGH 120, PUBLIC RECORDS OF PALM BEACH COUNTY, FLORIDA, AND ALL OF BRIGER PARCELS B, E AND F, AS RECORDED IN PLAT BOOK 90, PAGES 137 THROUGH 144, PUBLIC RECORDS OF PALM BEACH COUNTY, FLORIDA, SAID PARCEL BEING MORE PARTICULARLY DESCRIBED AS FOLLOWS:

COMMENCING AT THE NORTHWEST CORNER OF SAID BRIGER TRACT PLAT NO. 1; THENCE SOUTH 88°14'08" EAST, ALONG THE NORTH LINE OF SAID BRIGER TRACT PLAT NO. 1, A DISTANCE OF 379.44 FEET TO THE POINT OF BEGINNING; THENCE CONTINUE SOUTH 88°14'08" EAST ALONG THE NORTH LINE OF SAID BRIGER TRACT PLAT NO. 1, A DISTANCE OF 1280.56 FEET TO THE NORTHWEST CORNER OF THE LAKES OF LAGUNA, AS RECORDED IN PLAT BOOK 75, PAGES 162 THROUGH 165, PUBLIC RECORDS OF PALM BEACH COUNTY, FLORIDA; THENCE SOUTH 01°45'52" WEST ALONG THE WEST LINE OF SAID PLAT OF THE LAKES OF LAGUNA, A DISTANCE OF 376.00 FEET; THENCE SOUTH 88°14'08" EAST, A DISTANCE OF 10.00 FEET; THENCE SOUTH 01°45'52" WEST, A DISTANCE OF 248.68 FEET TO THE POINT OF CURVATURE OF A CURVE CONCAVE TO THE NORTHWEST; THENCE SOUTHWESTERLY ALONG THE ARC OF SAID CURVE, HAVING A CENTRAL ANGLE OF 20°51'06" AND A RADIUS OF 1058.00 FEET, A DISTANCE OF 385.04 FEET; THENCE SOUTH 67°23'02" EAST ALONG A LINE RADIAL TO SAID CURVE, A DISTANCE OF 80.00 FEET TO A POINT ON A CURVE CONCAVE TO THE NORTHWEST AND WHOSE CHORD BEARS SOUTH 30°33'09" WEST; THENCE SOUTHWESTERLY ALONG THE ARC OF SAID CURVE, HAVING A CENTRAL ANGLE OF 15°52'21" AND A RADIUS OF 1138.00 FEET, A DISTANCE OF 315.26 FEET; THENCE SOUTH 38°29'19" WEST, A DISTANCE OF 166.63 FEET; THENCE SOUTH 05°01'09" EAST, A DISTANCE OF 34.42 FEET TO A POINT ON A CURVE CONCAVE TO THE SOUTHWEST AND WHOSE CHORD BEARS SOUTH 43°04'31" EAST; THENCE SOUTHEASTERLY ALONG THE ARC OF SAID CURVE, HAVING A CENTRAL ANGLE OF 10°54'13" AND A RADIUS OF 1223.54 FEET, A DISTANCE OF 232.84 FEET TO A POINT ON THE SOUTH LINE OF SAID PLAT OF THE LAKES OF LAGUNA; THENCE SOUTH 87°38'08" EAST ALONG SAID SOUTH LINE, A DISTANCE OF 1082.78 FEET TO THE SOUTHEAST CORNER OF SAID PLAT OF THE LAKES OF LAGUNA AND A POINT ON THE EAST LINE OF SAID BRIGER TRACT PLAT NO. 1; THENCE SOUTH 02°21'52" WEST ALONG SAID EAST LINE, A DISTANCE OF 359.45 FEET; THENCE SOUTH 02°21'42" WEST, A DISTANCE OF 1273.20 FEET; THENCE NORTH 87°38'18" WEST, A DISTANCE OF 81.00 FEET; THENCE SOUTH 02°21'42" WEST, A DISTANCE OF 804.90 FEET; THENCE NORTH 88°19'12" WEST, A DISTANCE OF 219.02 FEET; THENCE SOUTH 02°21'42" WEST, A DISTANCE OF 20.00 FEET; THENCE NORTH 88°19'12" WEST, A DISTANCE OF 61.01 FEET; THENCE SOUTH 02°21'42" WEST, A DISTANCE OF 61.01 FEET TO A POINT ON THE NORTH LINE OF PARCEL 4 AS SHOWN ON SAID BRIGER TRACT PLAT NO. 1; THENCE SOUTH 88°19'12" EAST ALONG SAID NORTH LINE OF PARCEL 4, A DISTANCE OF 361.03 FEET TO A POINT ON THE EAST LINE OF SAID BRIGER TRACT PLAT NO. 1; THENCE SOUTH 02°21'42" WEST ALONG SAID EAST LINE, A DISTANCE OF 80.01 FEET TO THE SOUTHEAST CORNER OF SAID PARCEL 4; THENCE NORTH 88°19'12" WEST ALONG THE SOUTH LINE OF SAID PARCEL 4, A DISTANCE OF 361.03 FEET; THENCE SOUTH 02°21'42" WEST, A DISTANCE OF 339.02 FEET; THENCE NORTH 88°19'12" WEST, A DISTANCE OF 1189.66 FEET; THENCE NORTH 01°40'48" EAST, A DISTANCE OF 826.47 FEET; THENCE NORTH 11°39'13" WEST, A DISTANCE OF 49.33 FEET; THENCE NORTH 61°50'30" EAST, A DISTANCE OF 43.74 FEET; THENCE NORTH

THIS IS NOT A BOUNDARY SURVEY

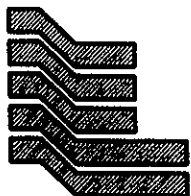

Landmark Surveying & Mapping Inc.

1850 FOREST HILL BOULEVARD, SUITE 100
 WEST PALM BEACH, FL 33406
 PHONE : (561) 433-5405
 LB #4396

FIELD:	N/A	DRAWN:	L.C.B.	SCALE:	N/A
BOOK:	N/A	DATE:	AUG., 2001	PROJ. FILE	2504
PAGE:	N/A	CHECKED:	C.S.P.	CADDFILE	2504_F

WESTBROOK
 AT BRIGER

22°04'18" WEST, A DISTANCE OF 252.47 FEET TO THE POINT OF CURVATURE OF A CURVE CONCAVE TO THE NORTHEAST; THENCE NORTHWESTERLY ALONG THE ARC OF SAID CURVE, HAVING A CENTRAL ANGLE OF 13°56'57" AND A RADIUS OF 50.00 FEET, A DISTANCE OF 12.17 FEET; THENCE NORTH 08°07'21" WEST, A DISTANCE OF 48.24 FEET; THENCE NORTH 12°06'07" WEST, A DISTANCE OF 185.07 FEET; THENCE NORTH 22°33'20" WEST, A DISTANCE OF 173.87 FEET TO THE POINT OF CURVATURE OF A CURVE CONCAVE TO THE SOUTHWEST; THENCE NORTHWESTERLY ALONG THE ARC OF SAID CURVE, HAVING A CENTRAL ANGLE OF 38°06'17" AND A RADIUS OF 50.00 FEET, A DISTANCE OF 33.25 FEET; THENCE NORTH 60°39'38" WEST, A DISTANCE OF 113.85 FEET TO THE POINT OF CURVATURE OF A CURVE CONCAVE TO THE NORTHEAST; THENCE NORTHWESTERLY ALONG THE ARC OF SAID CURVE HAVING A CENTRAL ANGLE OF 15°32'03" AND A RADIUS OF 50.00 FEET, A DISTANCE OF 13.56 FEET; THENCE NORTH 45°07'35" WEST, A DISTANCE OF 212.87 FEET TO THE POINT OF CURVATURE OF A CURVE CONCAVE TO THE SOUTHWEST; THENCE NORTHWESTERLY ALONG THE ARC OF SAID CURVE HAVING A CENTRAL ANGLE OF 40°52'09" AND A RADIUS OF 15.00 FEET, A DISTANCE OF 10.70 FEET; THENCE NORTH 85°59'44" WEST, A DISTANCE OF 43.41 FEET; THENCE SOUTH 03°56'43" WEST, A DISTANCE OF 38.51 FEET; THENCE NORTH 88°13'17" WEST, A DISTANCE OF 524.13 FEET; THENCE SOUTH 46°56'43" WEST, A DISTANCE OF 42.43 FEET TO A POINT ON THE EAST RIGHT-OF-WAY LINE OF MILITARY TRAIL AS PER OFFICIAL RECORD BOOK 4617, PAGE 1242, AND THE WEST LINE OF SAID BRIGER TRACT PLAT NO. 1; THENCE NORTH 01°56'43" EAST ALONG SAID EAST RIGHT-OF-WAY LINE OF MILITARY TRAIL AND WEST LINE OF BRIGER TRACT PLAT NO. 1, A DISTANCE OF 130.00 FEET; THENCE SOUTH 88°03'17" EAST, A DISTANCE OF 477.57 FEET; THENCE NORTH 03°56'43" EAST, A DISTANCE OF 68.98 FEET TO THE POINT OF CURVATURE OF A CURVE CONCAVE TO THE EAST; THENCE NORTHERLY ALONG THE ARC OF SAID CURVE HAVING A CENTRAL ANGLE OF 08°40'11", AND A RADIUS OF 1040.00, A DISTANCE OF 157.37 FEET; THENCE NORTH 12°36'54" EAST, A DISTANCE OF 70.51 FEET TO THE POINT OF CURVATURE OF A CURVE CONCAVE TO THE NORTHWEST; THENCE NORTHEASTERLY ALONG THE ARC OF SAID CURVE HAVING A CENTRAL ANGLE OF 02°06'56", AND A RADIUS OF 1960.00 FEET, A DISTANCE OF 72.37 FEET TO THE POINT OF COMPOUND CURVATURE OF A CURVE CONCAVE TO THE SOUTHWEST; THENCE NORTHWESTERLY ALONG THE ARC OF SAID CURVE HAVING A CENTRAL ANGLE OF 40°55'24", AND A RADIUS OF 25.00, A DISTANCE OF 17.86 FEET TO THE POINT OF REVERSE CURVATURE OF A CURVE CONCAVE TO THE SOUTH; THENCE NORTHERLY, EASTERLY, AND SOUTHERLY ALONG THE ARC OF SAID CURVE HAVING A CENTRAL ANGLE OF 260°13'32", AND A RADIUS OF 60.00 FEET, A DISTANCE OF 272.51 FEET TO THE POINT OF REVERSE CURVATURE OF A CURVE CONCAVE TO THE SOUTHEAST; THENCE SOUTHWESTERLY ALONG THE ARC OF SAID CURVE HAVING A CENTRAL ANGLE OF 39°21'12", AND A RADIUS OF 25.00 FEET, A DISTANCE OF 17.17 FEET TO THE POINT OF REVERSE CURVATURE OF A CURVE CONCAVE TO THE NORTHWEST; THENCE SOUTHWESTERLY ALONG THE ARC OF SAID CURVE HAVING A CENTRAL ANGLE OF 02°10'00", AND A RADIUS OF 2040.00 FEET, A DISTANCE OF 77.14 FEET; THENCE SOUTH 12°36'54" WEST, A DISTANCE OF 70.51 FEET; THENCE SOUTH 81°29'43" EAST, A DISTANCE OF 248.18 FEET TO THE POINT OF CURVATURE OF A CURVE CONCAVE TO THE SOUTHWEST; THENCE SOUTHEASTERLY ALONG THE ARC OF SAID CURVE HAVING A CENTRAL ANGLE OF 29°41'13", AND A RADIUS OF 108.00 FEET, A DISTANCE OF 55.96 FEET TO THE POINT OF REVERSE CURVATURE OF A CURVE CONCAVE TO THE NORTHWEST; THENCE NORTHEASTERLY ALONG THE ARC OF SAID CURVE HAVING A CENTRAL ANGLE OF 139°44'40" AND A RADIUS OF 128.29, A DISTANCE OF 312.89 FEET TO THE POINT OF REVERSE CURVATURE OF A CURVE CONCAVE TO THE EAST; THENCE NORTHERLY ALONG THE ARC OF SAID CURVE, HAVING A CENTRAL ANGLE OF 23°18'31" AND A RADIUS OF 300.00 FEET, A DISTANCE OF 122.04 FEET TO THE POINT OF COMPOUND CURVATURE OF A CURVE CONCAVE TO THE SOUTHEAST; THENCE NORTHEASTERLY ALONG THE

THIS IS NOT A BOUNDARY SURVEY

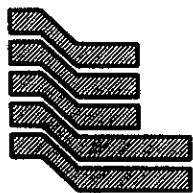

Landmark Surveying & Mapping Inc.

1850 FOREST HILL BOULEVARD, SUITE 100
 WEST PALM BEACH, FL 33406
 PHONE : (561) 433-5405
 LB #4396

FIELD:	N/A	DRAWN:	L.C.B.	SCALE:	N/A
BOOK:	N/A	DATE:	AUG., 2001	PROJ. FILE	2504
PAGE:	N/A	CHECKED:	C.S.P.	CADDFILE	2504_F

**WESTBROOK
 AT BRIGER**

SHEET NO. 2 OF 10 JOB NO. 2504

ARC OF SAID CURVE, HAVING A CENTRAL ANGLE OF 20°05'19" AND A RADIUS OF 730.00 FEET, A DISTANCE OF 255.95 FEET TO THE POINT OF COMPOUND CURVATURE OF A CURVE CONCAVE TO THE SOUTHEAST; THENCE NORTHEASTERLY ALONG THE ARC OF SAID CURVE HAVING A CENTRAL ANGLE OF 24°37'07" AND A RADIUS OF 493.00 FEET, A DISTANCE OF 211.83 FEET; THENCE NORTH 56°27'48" EAST, A DISTANCE OF 352.75 FEET TO A POINT ON A CURVE CONCAVE TO THE SOUTHWEST AND WHOSE CHORD BEARS NORTH 50°43'28" WEST; THENCE NORTHWESTERLY ALONG THE ARC OF SAID CURVE, HAVING A CENTRAL ANGLE OF 34°22'33" AND A RADIUS OF 1143.54 FEET, A DISTANCE OF 686.09 FEET; THENCE NORTH 67°54'45" WEST, A DISTANCE OF 128.84 FEET TO THE POINT OF CURVATURE OF A CURVE CONCAVE TO THE SOUTHWEST; THENCE NORTHWESTERLY ALONG THE ARC OF SAID CURVE, HAVING A CENTRAL ANGLE OF 20°08'33" AND A RADIUS OF 960.00 FEET, A DISTANCE OF 337.49 FEET; THENCE NORTH 88°03'17" WEST, A DISTANCE OF 75.45 FEET; THENCE SOUTH 84°48'07" WEST, A DISTANCE OF 80.42 FEET; THENCE NORTH 88°03'17" WEST, A DISTANCE OF 441.47 FEET TO A POINT ON THE WEST LINE OF SAID BRIGER TRACT PLAT NO. 1 AND SAID EAST RIGHT-OF-WAY LINE OF MILITARY TRAIL; THENCE NORTH 01°56'43" EAST ALONG SAID WEST LINE OF BRIGER TRACT PLAT NO. 1 AND SAID EAST RIGHT-OF-WAY LINE OF MILITARY TRAIL, A DISTANCE OF 100.00 FEET; THENCE SOUTH 88°03'17" EAST, A DISTANCE OF 339.00 FEET; THENCE NORTH 39°21'14" EAST, A DISTANCE OF 594.24 FEET; THENCE NORTH 01°56'43" EAST, A DISTANCE OF 316.96 FEET; THENCE NORTH 39°55'26" WEST, A DISTANCE OF 480.29 FEET TO THE POINT OF BEGINNING AFORE DESCRIBED.

CONTAINING 141.11 ACRES MORE OR LESS.

LEGEND

R = RADIUS
 L = ARC LENGTH
 Δ = CURVE CENTRAL ANGLE
 P.O.B. = POINT OF BEGINNING
 P.O.C. = POINT OF COMMENCEMENT
 P.B. = PLAT BOOK
 O.R.B. = OFFICIAL RECORD BOOK
 N/A = NOT APPLICABLE
 R.L. = RADIAL LINE
 R/W = RIGHT-OF-WAY

SURVEYOR AND MAPPER'S NOTES

1. NO SEARCH OF THE PUBLIC RECORDS WAS MADE BY THIS OFFICE.
2. BEARINGS AS SHOWN HEREON ARE BASED ON THE SOUTH LINE OF TRACT "O-1", BRIGER PARCELS B, E, AND F AS RECORDED IN PLAT BOOK 90, PAGES 138 THROUGH 144, PUBLIC RECORDS OF PALM BEACH COUNTY, FLORIDA, HAVING AN ASSUMED BEARING OF NORTH 88°19'12" WEST AND ALL OTHER BEARINGS ARE RELATIVE THERETO.

UNLESS THIS DOCUMENT BEARS THE SIGNATURE AND THE ORIGINAL RAISED SEAL OF A FLORIDA LICENSED SURVEYOR AND MAPPER, THIS DRAWING, MAP, SKETCH OR PLAT IS FOR INFORMATION PURPOSES ONLY AND IS NOT VALID.

DATE : AUGUST 7, 2001



CRAIG S. PUSEY
 PROFESSIONAL SURVEYOR AND MAPPER
 FLORIDA CERTIFICATE NO. 5019

THIS IS NOT A BOUNDARY SURVEY

Landmark Surveying & Mapping Inc.

1850 FOREST HILL BOULEVARD, SUITE 100
 WEST PALM BEACH, FL 33406
 PHONE : (561) 433-5405
 LB #4396

FIELD:	N/A	DRAWN:	L.C.B.	SCALE:	N/A
BOOK:	N/A	DATE:	AUG., 2001	PROJ. FILE	2504
PAGE:	N/A	CHECKED:	C.S.P.	CADDFILE	2504_F

**WESTBROOK
 AT BRIGER**

SHEET NO. 3 OF 10 JOB NO. 2504

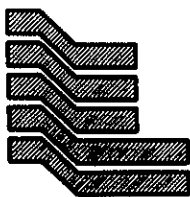

ARC OF SAID CURVE, HAVING A CENTRAL ANGLE OF 20°05'19" AND A RADIUS OF 730.00 FEET, A DISTANCE OF 255.95 FEET TO THE POINT OF COMPOUND CURVATURE OF A CURVE CONCAVE TO THE SOUTHEAST; THENCE NORTHEASTERLY ALONG THE ARC OF SAID CURVE HAVING A CENTRAL ANGLE OF 24°37'07" AND A RADIUS OF 493.00 FEET, A DISTANCE OF 211.83 FEET; THENCE NORTH 56°27'48" EAST, A DISTANCE OF 352.75 FEET TO A POINT ON A CURVE CONCAVE TO THE SOUTHWEST AND WHOSE CHORD BEARS NORTH 50°43'28" WEST; THENCE NORTHWESTERLY ALONG THE ARC OF SAID CURVE, HAVING A CENTRAL ANGLE OF 34°22'33" AND A RADIUS OF 1143.54 FEET, A DISTANCE OF 686.09 FEET; THENCE NORTH 67°54'45" WEST, A DISTANCE OF 128.84 FEET TO THE POINT OF CURVATURE OF A CURVE CONCAVE TO THE SOUTHWEST; THENCE NORTHWESTERLY ALONG THE ARC OF SAID CURVE, HAVING A CENTRAL ANGLE OF 20°08'33" AND A RADIUS OF 960.00 FEET, A DISTANCE OF 337.49 FEET; THENCE NORTH 88°03'17" WEST, A DISTANCE OF 75.45 FEET; THENCE SOUTH 84°48'07" WEST, A DISTANCE OF 80.42 FEET; THENCE NORTH 88°03'17" WEST, A DISTANCE OF 441.47 FEET TO A POINT ON THE WEST LINE OF SAID BRIGER TRACT PLAT NO. 1 AND SAID EAST RIGHT-OF-WAY LINE OF MILITARY TRAIL; THENCE NORTH 01°56'43" EAST ALONG SAID WEST LINE OF BRIGER TRACT PLAT NO. 1 AND SAID EAST RIGHT-OF-WAY LINE OF MILITARY TRAIL, A DISTANCE OF 100.00 FEET; THENCE SOUTH 88°03'17" EAST, A DISTANCE OF 339.00 FEET; THENCE NORTH 39°21'14" EAST, A DISTANCE OF 594.24 FEET; THENCE NORTH 01°56'43" EAST, A DISTANCE OF 316.96 FEET; THENCE NORTH 39°55'26" WEST, A DISTANCE OF 480.29 FEET TO THE POINT OF BEGINNING AFORE DESCRIBED.

CONTAINING 141.11 ACRES MORE OR LESS.

SURVEYOR AND MAPPER'S NOTES

1. NO SEARCH OF THE PUBLIC RECORDS WAS MADE BY THIS OFFICE.
2. BEARINGS AS SHOWN HEREON ARE BASED ON THE SOUTH LINE OF TRACT "0-1", BRIGER PARCELS B, E, AND F AS RECORDED IN PLAT BOOK 90, PAGES 138 THROUGH 144, PUBLIC RECORDS OF PALM BEACH COUNTY, FLORIDA, HAVING AN ASSUMED BEARING OF NORTH 88°19'12" WEST AND ALL OTHER BEARINGS ARE RELATIVE THERETO.

UNLESS THIS DOCUMENT BEARS THE SIGNATURE AND THE ORIGINAL RAISED SEAL OF A FLORIDA LICENSED SURVEYOR AND MAPPER, THIS DRAWING, MAP, SKETCH OR PLAT IS FOR INFORMATION PURPOSES ONLY AND IS NOT VALID.

DATE : AUGUST 7, 2001

 CRAIG S. PUSEY
 PROFESSIONAL SURVEYOR AND MAPPER
 FLORIDA CERTIFICATE NO. 5019

THIS IS NOT A BOUNDARY SURVEY

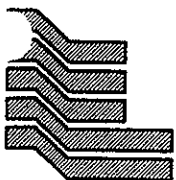

Landmark Surveying & Mapping Inc.

1850 FOREST HILL BOULEVARD, SUITE 100
 WEST PALM BEACH, FL 33406
 PHONE : (561) 433-5405
 LB #4396

WESTBROOK

FIELD:	N/A	DRAWN:	L.C.B.	SCALE:	N/A
BOOK:	N/A	DATE:	AUG., 2001	PROJ. FILE	2504
PAGE:	N/A	CHECKED:	C.S.P.	CADDFILE	2504_F

SHEET NO. 3 OF 9 JOB NO. 2504